

## 215-133

### Product Features

- Straight forward installation
- Dimming range 1%...100%
- Suitable for 1-10V LED dimming driver
- Switch function
- PC material, high flame retardant
- Fashion, and easy to use
- Used in the bedroom, restaurant, bars and other places need dimming control

### Technical Data

Model	215-133
Output	1-10v signal
Max.input current	40mA
The number of driver connected to dimmer	30
Switch	10A
Size	83.5x83.5x44mm
Weight	90g
Working temp	-10 C -50 C

The total amount of input currents must not exceed 40 mA. For example there are 30 1-10V dimming driver (control current 1.3mA). Please use only driver of one manufacturer, type and power.

### Installing the dimmer

#### Wiring the dimmer for the desired application.

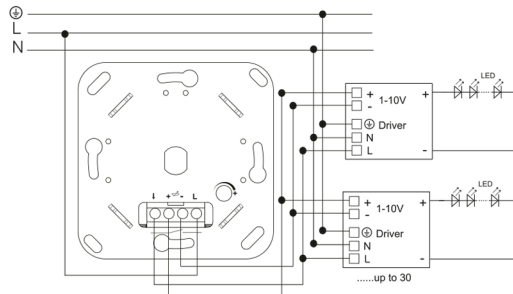

#### Setting the minimum brightness of the lamps.

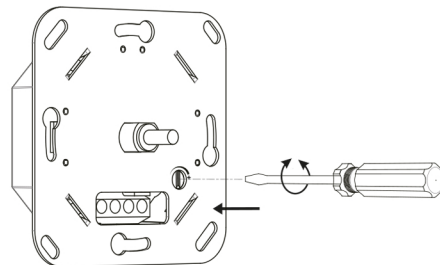

- Switch the dimmer on.
- Dim the brightness right down using the rotary knob.
- Set the minimum brightness using the set-screw (+).

#### Installing the dimmer and covers.

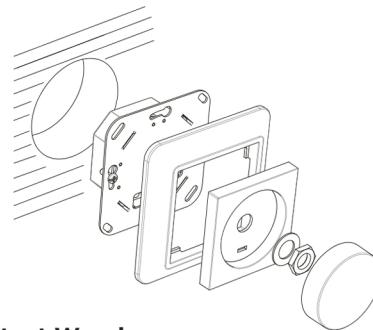

### Important Warning

- Disconnect power at the main switchboard before installation
- Two or more dimmers cannot be connected in parallel or series to control the same load
- Ensure that the positive and negative leads of the control line are correctly connected.